

PROPOSTA DI VARIANTE AL PIANO URBANISTICO ATTUATIVO PER IL COMPARTO INDUSTRIALE DI WAMGROUP S.p.a.

RESPONSABILE DEL PROGETTO Arch. Franco Rebecchi R&S2 Architetti Studio Associato



Table with project details: DOCUMENTO (TAV), ELABORATO (03), DATA (10/03/2014), OGGETTO (STATO APPROVATO), and PROPRIETA' (WAMGROUP S.p.a).

WAMGROUP S.p.a Via Cavour, n° 338/a - 41032 Ponte Motta - Cavezzo (MO)

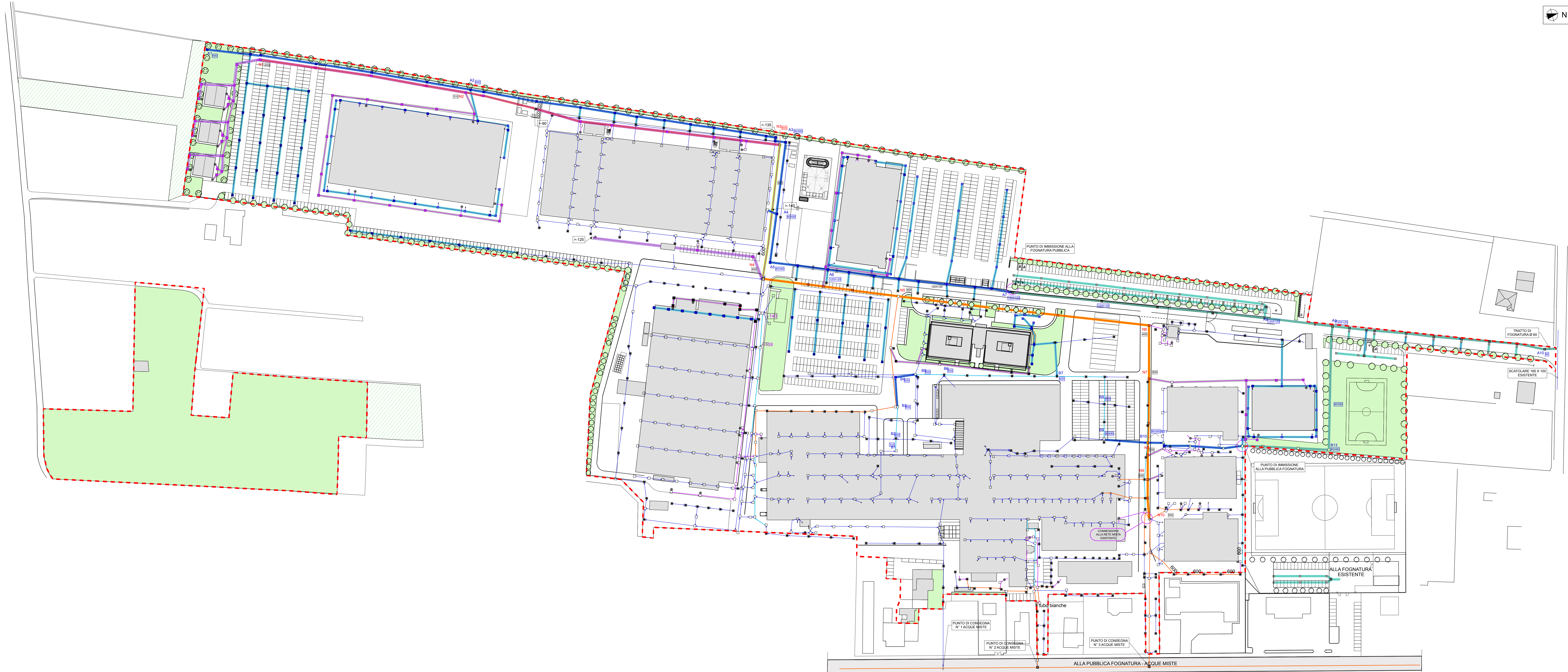

Legend (LEGENDA) defining symbols for existing and new sewerage infrastructure, including collectors, secondary branches, manholes, and connection points.